



Ramsey Winch Company OWNER'S MANUAL ATV Electric Winch Model ATV3000 with Synthetic Rope



Note: Fairlead does not attach directly to winch.

ATV3000 Winch						
LAYER OF ROPE		1	2	3	4	5
Rated Line Pull per Layer	(lbs)	3,000	2,500	2,100	1,890	1,680
	(Kg)	1,350	1,133	952	857	761
Cumulative rope capacity per layer (3/16"-4.8mm dia. rope)	(ft)*	7	15	25	37	50
	(m)*	2.12	4.56	7.6	11.3	15.2

* ROPE MUST BE UNIFORMLY WOUND ONTO DRUM.

Line Pull	(lbs)	NO	500	1,000	1,500	2,000	2,500	3,000
First Layer	(Kg)	LOAD	227	453	680	906	1,133	1,360
Line Speed	(fpm)	20.8	17.6	15	12.3	10.2	8.5	5.0
First Layer	(mpm)	6.3	5.3	4.5	3.8	3.0	2.6	1.5
Amp Draw	(12v)	18	45	63	84	96	121	150

Congratulations

You have purchased the finest winch available in its service class. It features a highly efficient 3 stage planetary gear set which transmits torque from a permanent magnet motor. A safe positive clutch allows free spooling for quick rope deployment. Your Ramsey winch was designed and manufactured to provide you with the utmost in utility. As with any device that combines power and movement in its use, there are dangers if improperly used. At the same time, there are easier and faster ways for getting the job done if certain precautions are taken first. Please read this manual carefully. It contains useful ideas in obtaining the most efficient operation from your Ramsey Winch and safety procedures you need to know before beginning use. When you follow our guidelines for operation, your Ramsey winch will give you many years of satisfying service. Thank you for choosing Ramsey. You will be glad you have one working for you.

Please Note: Ramsey ATV 3000 winches are designed for ATV use. The winches are not designed for and should not be used in industrial applications (car haulers /carriers, wreckers, hoisting, etc.), and Ramsey does not warrant them to be suitable for such use. Ramsey makes a separate, complete line of winches for industrial/commercial use. Please contact the factory for further information.



CAUTION: Read and understand this manual before installation and operation of winch. See Safety Precautions.

Contents

Performance Specifications	cover
Safety Precautions	2
Tips for Safe Operation	2-3
Techniques of Operation	3
General Installation	4
Operating Instructions	4
Wireless Remote Control Operation	4
Trouble Shooting Guide	5
Maintenance	6
Rope Maintenance	6
Rope Installation	6
Rope Inspection	7
Rotating the Motor	8-9
Electrical Schematic	10
Winch Parts List	10-11
Warranty	back cover

- G. Modification, alteration, or deviation to the winch should only be made by Ramsey Winch Company.
- I. Keep the duration of your pulls as short as possible. If the motor becomes uncomfortably hot to the touch, stop and let it cool for a few minutes. Do not pull more than one minute at or near the rated load. Do not maintain power to the winch if the motor stalls. Electric winches are for intermittent usage and should not be used in constant duty applications.
- J. Do not use winch in hoisting applications due to required hoist safety factors and features.
- K. Do not exceed maximum line pull ratings shown in tables. Shock loads must not exceed these ratings.
- L. To respool correctly, it is necessary to keep a slight load on the rope. Do not allow the rope to slip through your hand and do not approach the winch too closely. When all the rope except a few feet is in, stop and finish spooling in rope by rotating the drum by hand with clutch disengaged. Always use hook strap to hold hook when spooling.

Safety Precautions To Guard Against Possible Injury.....



A minimum of FIVE wraps of synthetic rope around the drum barrel is required to hold the load. The anchor puck is not designed to hold the load.

- A. Keep yourself and others a safe distance to the side of the rope when pulling under load.
- B. Do not step over a rope, or near a rope under load.
- C. Use supplied hook strap when handling hook for spooling rope.
- D. Do not use the ATV to pull a load on the winch rope. This could result in rope breakage and/or winch damage
- E. Apply blocks to wheels when ATV is on an incline.
- F. Winch clutch should be disengaged when winch is not in use and fully engaged when in use.



Tips for Safe Operation

Don't underestimate the potential danger in winching operations. Neither should you fear them. Do learn the basic dangers and avoid them.

Observe spooling of rope onto drum. Side pulls can cause rope to pileup at one end of the drum. To correct uneven stacking, spool out that section of the rope and move it to the other end of the drum and continue winching. Uneven spooling which causes rope pileup can interfere with the winch tie rods causing damage to the winch.

Store the wireless remote control transmitter in a safe place where it will not become damaged. Inspect it before you use it.

When ready to begin winching, push and hold the On/Off button on the transmitter until it flashes. Do not engage clutch with motor running.

Never connect the hook back to the rope. This causes rope damage. Always use a sling or chain of suitable strength.

Observe your winch while winching. If possible, while standing at a safe distance. If you use ATV drive to assist, stop and get off every few feet to assure the rope is not piling up in one corner. Jamming rope can break your winch.

Do not attach tow hooks to winch mounting apparatus. They must attach to ATV frame.

When double lining during stationary winching, the winch hook should be attached to the chassis of the ATV. Since the greatest pulling power is achieved on the innermost layer of your winch, it is desirable to pull off as much line as you can for heavy pulls. If this is not practical, use a snatch block and double line arrangement.

Neat, tight spooling avoids rope binding which is caused when a load is applied and the rope is pinched between two other wraps of rope. If this happens, alternately power the winch in and out a few inches. Do not attempt to work a bound rope under load, free by hand.

Do not expose rope to chemicals or heat sources.

Avoid prolonged exposure of synthetic rope to ultraviolet rays from sunlight which can degrade rope strength over time. Use a winch cover over winch and rope when not in use.

Any sharp bend in the rope under load decreases its strength substantially and may cause premature damage or failure. Sheave diameters on rotating snatch blocks should be at least 8 times the rope diameter (1-1/2" for 3/16" rope).

Avoid pulling rope over rough surfaces or sharp edges. Slide the protective sleeve along the length of the rope to place it at a location where the rope would encounter rough surfaces such as rock or tree branches.

See *Rope Inspection*, page 7 for information on when to replace the synthetic rope.

Techniques of Operation

The best way to get acquainted with how your winch operates is to make a few test runs before you actually need to use it. Plan your test in advance. Remember you hear your winch as well as see it operate. Get to recognize the sound of a light steady pull, a heavy pull, and sounds caused by load jerking or shifting. Soon you will gain confidence in operating your winch and its use will become second nature with you.

Your winch will not only pull your ATV up or ease your ATV down a steep grade, it will also pull another ATV or a load while your ATV is anchored in a stationary position.

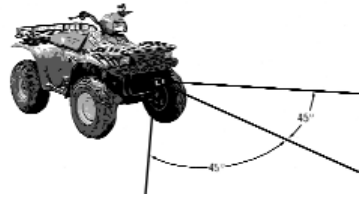

Winches equipped with a fairlead can pull from several directions. Pull from an angle only to straighten up the ATV—otherwise you can damage structural members or other parts of your ATV and cause excess rope buildup on one end of the winch drum.

When pulling a heavy load, place a blanket, jacket or tarpaulin over the rope five or six feet from the hook. It will slow the snap back in the event of a broken rope.

Use the ATV wheel power to help the winch, but don't overtake the winch line. Plan your pull. You can't always hook up and pull out in one step. Examine all the areas for anchoring possibilities as well as leverage situations, direction, and goal.



For basic self-recovery, anchor to a tree or heavy rock. When anchoring to a tree, always use a tree trunk protector.

General Installation

The winch shown in this owner's manual is solely and exclusively designed for ATV mounted, non-industrial applications. All other applications will void warranty.

1. Install Winch and Mounting Kit according to instructions supplied with Mounting Kit. Tighten mounting bolts to 16 ft-lbs torque.
2. Mount Aluminum Hawse Fairlead supplied with winch according to Mounting Kit instructions using 3/8-16UNC x 1" bolts (discard extra set of 3/8-16 x 3/4" bolts).
3. **It is very important that the winch be mounted on a flat surface, with the rope feeding from the bottom of the drum.**

CAUTION: SUPPLIED 5/16-18UNC x 1" LONG MOUNTING BOLTS WITH LOCKWASHERS ARE FOR A RECOMMENDED WINCH MOUNTING PLATE THICKNESS OF 3/16". IF A DIFFERENT MOUNTING PLATE THICKNESS IS USED, THE BOLT LENGTH MUST BE ADJUSTED ACCORDINGLY OR DAMAGE TO WINCH MAY OCCUR. REPLACEMENT BOLTS MUST BE SAE GRADE 5 OR EQUIVALENT.

4. Do not attach motor and battery leads until instructed to do so.
5. Refer to installation instructions for the Wireless Remote Switch (in the *ATV Wireless Installation and Operation Manual*) for installation of the switch and electrical assemblies for the winch.

Operating Instructions

The winch clutch allows rapid unspooling of the wire rope for hooking onto the load or anchor point. The clutch is operated by the shifter located on the end of the winch as follows:

1. To disengage the clutch, turn the clutch shifter to the "FREESPOOL" position. Wire rope may now be freespoiled off the drum.
2. To engage the clutch, turn the clutch shifter to the "ENGAGED" position. The winch is now ready for pulling.

Your battery must be kept in good condition. A fully charged battery and proper connections are essential. Run the ATV engine during winching operations to keep battery charged.

Wireless Remote Control Operation

CAUTION: WHEN THE TRANSMITTER REACHES A TEMPERATURE BELOW 0°F (-18°C) IT WILL NOT OPERATE. IN EXTREMELY COLD TEMPERATURES, KEEP TRANSMITTER IN A POCKET OF INNERMOST LAYER OF CLOTHING WHEN NOT IN USE.

The transmitter has push buttons labeled according to their function. Make sure the motor has stopped fully before reversing to prevent premature solenoid failure. To operate the winch hold "ON/OFF" button for 2 seconds to activate the "IN" and "OUT" functions. Run winch forward and reverse to check connection and to verify winch operating directions.

The transmitter is clearly labeled and a red LED flashes when the winch is in operation.

Pushing both buttons at the same time will not damage your winch in any way.

Press and hold the "ON/OFF" button on the transmitter to disable the transmitter when winch is not in use. This will prolong the battery life of the transmitter. The transmitter automatically turns off after 20 minutes.

Refer to page 5 of Remote Control Installation Instructions for remote operation notes.



ATV3000 Trouble Shooting Guide

CONDITIONS	POSSIBLE CAUSE	CORRECTION
MOTOR RUNS IN ONLY ONE DIRECTION	Defective solenoid or stuck solenoid. Defective remote control or low battery in transmitter.	Jar solenoid assembly to free contacts. Check each solenoid by applying +12 volts to coil terminal (it should make an audible click when energized). Check winch operation with auxilliary toggle switch. Check battery in transmitter.
MOTOR RUNS EXTREMELY HOT	Long period of operation.	Cooling-off periods are essential to prevent overheating.
MOTOR RUNS, BUT WITH INSUFFICIENT POWER OR WITH LOW LINE SPEED	Insufficient battery. Bad connection. Insufficient charging system.	Test for faulty vehicle battery. Check battery cable for corrosion; clean and grease. Replace with larger capacity charging system.
MOTOR RUNS, BUT DRUM DOES NOT TURN	Clutch not engaged.	If clutch engaged but symptoms still exist, it will be necessary to disassemble winch to determine cause and repair.
MOTOR WILL NOT OPERATE	Defective solenoid or stuck solenoid. Defective remote control or low battery in transmitter. Defective motor. Loose connections.	Jar solenoid assembly to free contacts. Check each solenoid by applying +12 volts to coil terminal (it should make an audible click when energized). Check winch operation with auxilliary toggle switch. Check battery in transmitter. If solenoids operate, check for voltage at armature post; replace motor. Check all electrical connections from the battery to the motor.
MOTOR WATER DAMAGED	Submerged in water or water from high pressure car wash.	Allow to drain and dry thoroughly, then run motor without a load in short bursts to dry windings.
WINCH RUNS IN OPPOSITE DIRECTION OF TRANSMITTER BUTTONS	Motor leads crossed. Solenoid control wires crossed.	Reverse electrical connections to motor. Reverse position of green and yellow wires on solenoid assembly.

Maintenance

Corrosion on electrical connections will reduce performance or may cause a short. Clean all connections. In salty environments use a silicone sealer to protect from corrosion.

To minimize corrosion of the internal motor components that may occur due to condensation, power the winch in or out periodically. Energizing the motor will generate heat, which will help dissipate any moisture buildup in the motor. This should be performed at periodic intervals (such as with each oil change of your vehicle). Note: Refer to Troubleshooting Guide if the motor has been submerged.

See supplied instructions for programming a replacement transmitter.

All moving parts in the winch are permanently lubricated with broad temperature range lithium based grease.

Rope Maintenance

The most important part of maintenance of the synthetic rope is to inspect it regularly. Any time the winch is used, the synthetic rope should be inspected thoroughly as described on the opposite page.

Likewise, inspect the protective sleeve and replace if it becomes torn, fused, or threadbare.

Keep the rope and protective sleeve free of moisture, grease, dirt or other debris. If necessary, clean with a damp cloth.

Rope Installation

Notes:

- **Rope should be installed so that it feeds from the bottom of the drum.**
- **An Aluminum Hawse Fairlead, P/N 251267, is recommended for use with the Ramsey Synthetic Rope.**
- **Before installing synthetic rope, inspect winch drum and smooth any sharp edges on drum barrel, flanges and other winch accessories that may contact the rope.**

1. Unwind the new rope by rolling it out along the ground.
2. Feed the synthetic rope through the aluminum hawse fairlead and under the drum.
3. Slide the taped end of the synthetic rope through the narrow end of the pocket against drum flange and wrap the rope around the anchor puck. Pull the rope and puck back into the wide end of the pocket leaving approximately 1/8" beyond edge of pocket as shown. Pull firmly on the rope to fully seat the rope and puck into the pocket.

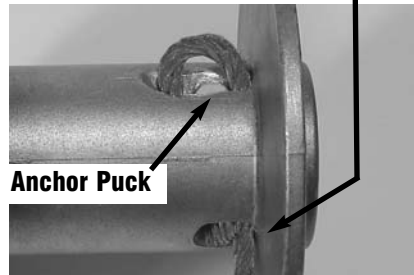

4. Carefully run winch in the "reel-in" direction. Keeping tension on end of rope, spool all the rope onto the drum, taking care to form neatly wrapped layers.

Rope Inspection

When rope is first used, the outer filaments of the rope will quickly fuzz up. This is the result of these filaments breaking and this roughened surface will actually protect the fibers underneath. The condition should stabilize, not progress. If the surface roughness increases, excessive abrasion is taking place and strength is being lost.

Look closely at both the inner and outer fibers. When either is worn the rope is obviously weakened. Open the strands and look for powdered fiber--this is a sign of internal wear.

Rope should be replaced when

- **Rope bulk anywhere along the length is reduced by 25% or more by abrasion**
- **Two or more adjacent strands are cut.**
- **Flat areas or lumps are found that are not eliminated by flexing rope.**
- **Excessive fused or melted fibers are found. Any such areas will be stiff and the rope will have a glazed appearance.**

Examples:



Rope with original bulk



Rope displaying 25% strand volume reduction from abrasion--**rope should be replaced.**



Rope strand showing full volume



Rope strand reduced by 25% abrasion--**rope should be replaced.**



Rope exhibits fiber-set from compression. A slight sheen is visible. This is not a permanent characteristic and can be eliminated by flexing the rope.



Rope displays two adjacent cut strands--**rope should be replaced.**

Rotating the Motor on your ATV Winch

The ATV winch has the motor studs and leads positioned on the end of the motor aligned vertically. If you need to rotate the motor on your ATV winch to gain clearance, you can rotate the motor 90°. The motor studs will then be aligned horizontally.

Before you begin:

1. Remove the rope from the drum. Turn the clutch handle to Freespool and pull rope off. Slide the end of the rope out of the pocket next to the drum flange until the rope anchor can be removed. Be sure to keep the rope anchor for re-installing the rope. Leave the clutch set to Freespool.
2. Disconnect the motor leads.
3. Remove the winch from its mounting channel. Place it on a sturdy, level workbench.

Set the winch down on the clutch end.

1. Remove the tie bar bolts and nuts. Pull tie bars from between end bearings.
2. Lift the motor end off the drum and set down with the motor end down. Make sure the shaft, drum bushing and spring stay with the drum.

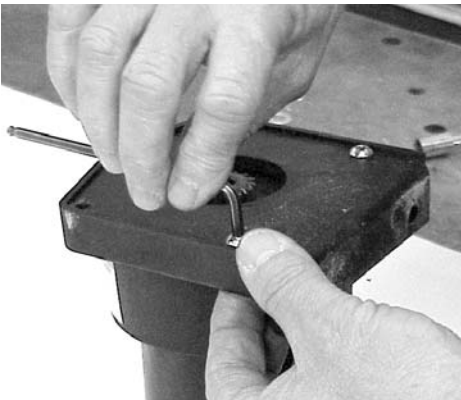
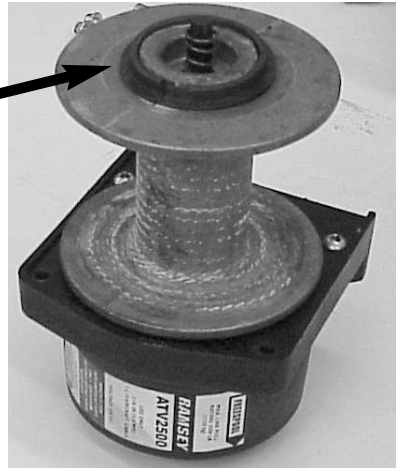

3. Remove the bolts that hold the end plate to the motor end housing. Lift off the end plate and take the nuts and washers out of the mounting feet. Set aside the gear assemblies and bushing. The input sun and planetary gear carrier may come out together.

- Lean the motor end and loosen the motor tie bolts off the tie bolt nuts. Lean the motor end back up so that it is sitting upright. **Do not let the motor end cap come apart from the rest of the motor.** Lift the motor end housing and rotate 90°. Put the tie bolt nuts in the other set of pockets and carefully lean the motor end back. Tighten the tie bolts to 45-50 in-lbs. torque. Do not overtighten.



- After rotating the motor, the motor end will appear as shown at right. The motor studs will be aligned horizontally, and the motor tie bolt nuts will be in the other set of pockets.

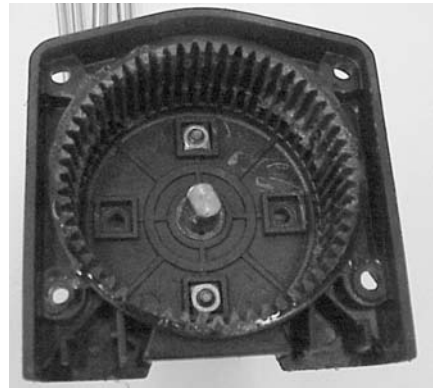

- Replace the gears into the motor end housing, fitting the input sun gear over the motor shaft. The planetary gear carrier should be seated so that the bushing, as shown at lower right, is flush with the ring gear.

Insert the mounting nuts and washers into the pockets of the housing as shown. Make sure they do not fall out while re-installing the end plate.

- Re-install the end plate on the housing with the bolts you removed earlier. Tighten these bolts to 45-50 in-lbs. torque. Do not overtighten.
- Lift the motor end assembly onto the drum. Turn the drum and motor end assembly so that the shaft fits into the input sun gear.

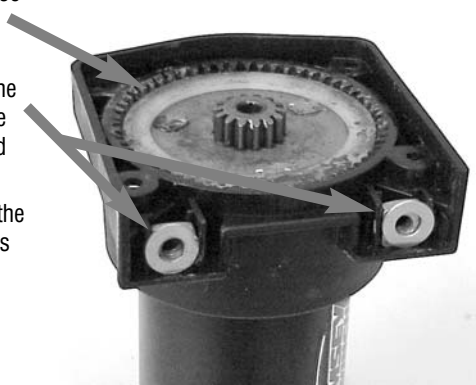

Lean the motor end assembly slightly to one side to insert the tie bars into their holes.

- Slide the tie bar bolts through the tie bars and into their nuts. Tighten the tie bar bolts to 45-50 in-lbs. torque. Do not over tighten. The finished winch should look as shown below, with the motor studs aligned horizontally.

Confirm that the drum freespools properly without binding.

Refer to the winch mounting kit installation instructions for re-installing the winch. Re-install the winch rope according to the instructions in this manual.

Winch Parts List ATV3000 (Wireless Remote)

ITEM NO.	QTY.	PART NO.	DESCRIPTION
1	1	251214	MOTOR KIT
2	1	251189	MOTOR END GEAR SET
3	1	251191	CLUTCH KIT
4	1	251192	DRUM KIT
5	1	251268	SYNTHETIC ROPE KIT
6	1	251194	CLUTCH END GEAR KIT
7	1	251267	ALUMINUM HAWSE FAIRLEAD
8	1	251195	BUSHING KIT
9	1	251196	TIE BAR KIT
10	1	251197	ELECTRICAL WIRING KIT
11	1	282058	WIRELESS RECEIVER & TRANSMITTER KIT
12	1	251190	WIRELESS TRANSMITTER
13	1	251234	SOLENOID KIT
14	1	251235	TOGGLE SWITCH
15	1	251198	ANTENNA KIT
16	1	257522	HARDWARE KIT*

Electrical Schematic (Wireless Remote)

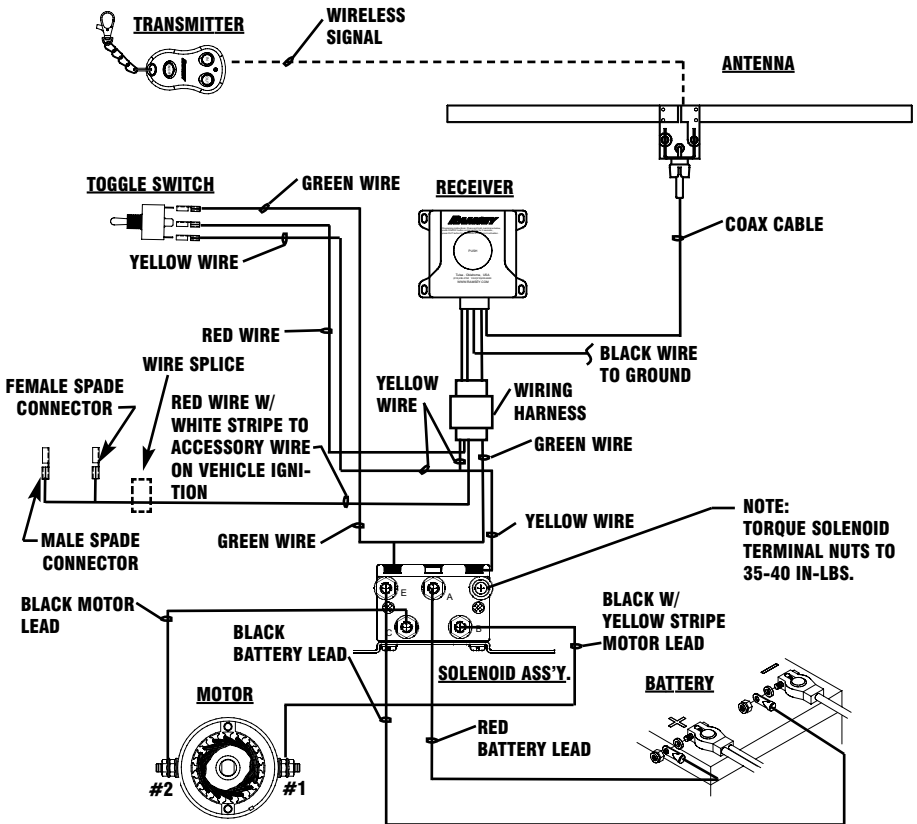

RAMSEY ATV3000 (Wireless Remote)

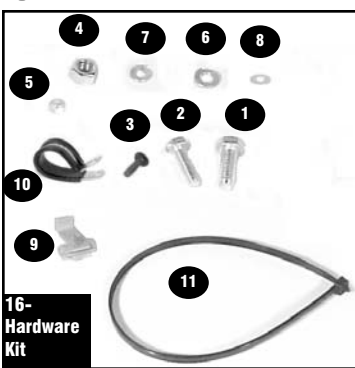
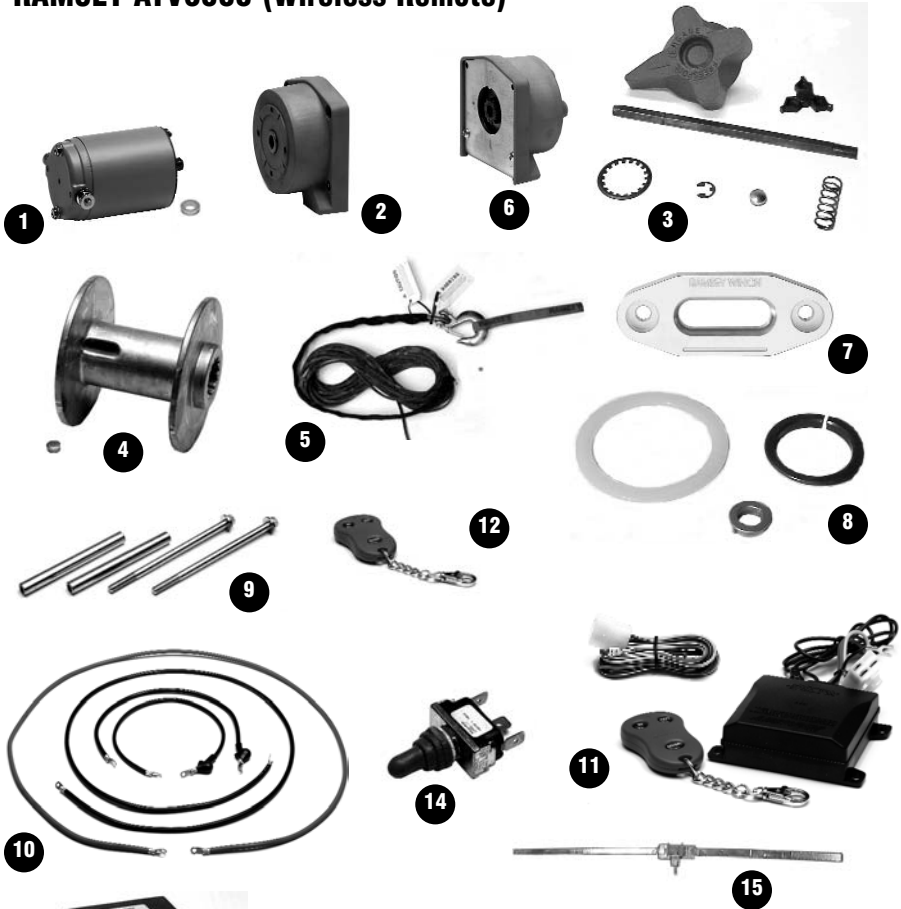

***Hardware Kit**

Item No.	Qty.	Description
16-1	4	5/16-18UNC x 1" Hx Hd Z/P GR5 Capscrew
16-2	2	3/8-16UNC x 1" Hx Hd Z/P GR5 Capscrew
16-3	2	#10-24UNC x 3/4" Truss Cross-recess F/B Capscrew
16-4	2	3/8-16UNC Hx GR2 Z/P Nut
16-5	2	#10-24UNC Hx Locknut
16-6	4	5/16 Med Z/P Lockwasher
16-7	2	3/8 Med Z/P Lockwasher
16-8	2	#10 Flat Washer Z/P
16-9	1	Wire Splice
16-10	2	Tube Clamp
16-11	1 pkg	Cable Ties

Warranty Information

Ramsey Winches are designed and built to exacting specifications. Care and skill go into every winch we make. If the need should arise, warranty procedure is outlined on the back of your self-addressed, postage paid warranty card. Please read and fill out the enclosed warranty card and send it to Ramsey Winch Company. If you have any problems with your winch, please follow instructions for prompt service on all warranty claims.

Limited Lifetime Warranty

Ramsey Winch offers a limited lifetime warranty for each new Ramsey ATV winch against manufacturing defects in workmanship and materials on all manufactured components.

Warranty registration cards for each winch must be submitted at the time of purchase, or within 90 days. Online registration of your winch is available at www.ramsey.com.

New rope assemblies are warranted against defects in workmanship and materials. No warranty applies after initial use.

All Ramsey mounting kits and other accessories carry a 1-year limited warranty against defects in materials and workmanship.

This warranty is void if winch is used in industrial applications.

Electrical components consisting of motors, solenoids, wiring, wire connectors, and associated parts carry a limited 1-year warranty.

The obligation under this warranty, statutory or otherwise, is limited to the replacement or repair at the manufacturer's factory, or at a point designated by the manufacturer, of such part as shall appear to the manufacturer, upon inspection of such part, to have been defective in material or workmanship. This Warranty does not obligate Ramsey Winch Company to bear the cost of transportation charges in connection with the replacement or repair of defective parts, nor shall it apply to a product upon which repairs or alterations have been made, unless authorized by the manufacturer, or for equipment misused, neglected, or improperly installed.

Important notice: To the fullest extent permitted by applicable law, the following are hereby excluded and disclaimed: 1. All warranties of fitness for a particular purpose; 2. All warranties of merchantability; 3. All claims for consequential or incidental damages. There are no warranties that extend beyond the description that appears on the face hereof.

Some states do not allow the above exclusions or disclaimers in consumer transactions and as such this disclaimer/exclusion may not apply to your particular case.

To the extent such warranties of fitness for a particular purpose or merchantability are deemed to apply to this product, they exist only for so long as the express limited warranty elsewhere set forth is in existence.

Ramsey Winch Company makes no warranty in respect to accessories, same being subject to the warranties of their respective manufacturers.

Ramsey Winch Company, whose policy is one of continuous product improvement, reserves the right to improve any product through changes in design or materials as it may deem desirable without being obligated to incorporate such changes in products of previous manufacture.

If field service at the request of the buyer is rendered and the fault is found not to be with Ramsey Winch Company's product, the buyer shall pay the time and expense of the field representative. Bills for service, labor or other expenses which have been incurred by the buyer without express approval or authorization by Ramsey Winch Company will not be accepted.

This Warranty gives you specific legal rights and you may also have other legal rights which vary from state to state.



RAMSEY WINCH COMPANY
P.O. BOX 581510 TULSA, OKLAHOMA 74158-1510 USA PHONE: (918) 438-2760 FAX: (918) 438-6888
<http://www.ramsey.com>

OM-914167-0905-B