

**Ramsey Winch Company
OWNER'S MANUAL
BADGER Electric Winch
Model BADGER 2500**

Note: Fairlead does not attach directly to winch. Winch shown with mounting plate, sold separately.

BADGER 2500 WINCH					
LAYER OF CABLE	1	2	3	4	5
Rated line pull per layer (lbs)	2500	2090	1800	1580	1400
(kgs)	1133	947	815	716	634
Cumulative cable capacity per layer (3/16" - 4.8mm - dia. cable)	(ft)* 7	15	25	37	50
(m)*	2.12	4.56	7.6	11.3	15.2

*CABLE MUST BE UNIFORMLY WOUND ONTO DRUM.

Line pull first layer	(lbs) (kgs)	NO LOAD	500 227	1000 453	1500 680	2000 906	2500 1133
Line speed first layer	(fpm) (mpm)	18 5.5	17 5.1	15 4.6	12 3.7	11 3.4	7.5 2.3
Amp draw	(12v)	36	60	90	116	140	160

Congratulations

You have purchased the finest winch available in its service class. It features a highly efficient 3 stage planetary gear set which transmits torque from a permanent magnet motor. A safe positive clutch allows free spooling for quick cable deployment. Your Ramsey winch was designed and manufactured to provide you with the utmost in utility. As with any device that combines power and movement in its use, there are dangers if improperly used. At the same time, there are easier and faster ways for getting the job done if certain precautions are taken first. Please read this manual carefully. It contains useful ideas in obtaining the most efficient operation

from your Ramsey Winch and safety procedures you need to know before beginning use. When you follow our guidelines for operation, your Ramsey winch will give you many years of satisfying service. Thank you for choosing Ramsey. You will be glad you have one working for you.

Please Note: Ramsey Badger 2500 winches are designed primarily for general use. This winch is not designed to be used in industrial applications (car haulers/carriers, wreckers, hoisting, etc.), and Ramsey does not warrant it to be suitable for such use. Ramsey makes a separate, complete line of winches for industrial/commercial use. Please contact the factory for further information.

 **CAUTION: Read and understand this manual before installation and operation of winch. See Safety Precautions.**

Contents

Performance Specifications.....	cover
Safety Precautions	1
Tips for Safe Operation	1
Techniques of Operation	2
General Operating Instructions ..	2
General Installation	3
Maintenance	3
Cable Installation.....	3
Winch Mounting.....	4
Solenoid Mounting.....	4
Electrical Schematic.....	5
Electrical Connections & Oper. .	5
Winch Parts List	6
Trouble Shooting Guide	7
Warranty	back cover



Safety Precautions To Guard Against Possible Injury

- A. Keep yourself and others a safe distance to the side of the cable when pulling under load.
- B. Do not step over a cable, or near a cable under load.
- C. Use supplied hook strap when handling hook for spooling wire rope.
- D. Do not use a vehicle to pull a load on the winch cable. This could result in cable break age and/or winch damage.
- E. Use a heavy rag or gloves to protect hands from burrs when handling winch cable.
- F. Apply blocks to wheels when vehicle is on an incline.
- G. Winch clutch should be disengaged when winch is not in use and fully engaged when in use.
- H. Modification, alteration, or deviation to the winch should only be made by Ramsey Winch Company.
- I. Keep the duration of your pulls as short as possible. If the motor becomes uncomfortably hot to the touch, stop and let it cool for a few minutes. Do not pull more than one minute at or near the rated load. Do not maintain power to the winch if the motor stalls.
Electric winches are for intermittent usage and

should not be used in constant duty applications.

- J. Disconnect the remote control switch from the winch when not in use. A Ramsey Part No. 282053 safety on-off switch is recommended.
- K. Do not use winch in hoisting applications due to required hoist safety factors and features.
- L. Do not exceed maximum line pull ratings shown in tables. Shock loads must not exceed these ratings.
- M. To respool correctly, it is necessary to keep a slight load on the cable. Do not allow the cable to slip through your hand and do not approach the winch too closely. When all the cable except a few feet is in, stop and finish spooling in cable by rotating the drum by hand with clutch disengaged. Always use hook strap to hold hook when spooling.
- N. Do not use the winch to hold a load on the trailer while towing. Secure the load to the trailer with straps or tie-downs. The winch is not designed to be a load holding device.



Tips for Safe Operation

Don't underestimate the potential danger in winching operations. Neither should you fear them. Do learn the basic dangers and avoid them. Observe spooling of cable onto drum. Side pulls can cause cable to pileup at one end of the drum. To correct uneven stacking, spool out that section of the cable and move it to the other end of the drum and continue winching. Uneven spooling which causes cable pileup can interfere with the winch tie rods causing damage to the winch. Store the remote control switch in a safe place where it will not become damaged. Inspect it before you plug it in. When ready to begin spooling in, plug in remote control switch with clutch disengaged. Do not engage clutch with motor running. Never connect the hook back to the cable. This causes cable damage. Always use a sling or chain of suitable strength.

Observe your winch while winching. If possible, while standing at a safe distance.

If you use vehicle drive to assist, stop and get out every few feet to assure the cable is not piling up in one corner. Jamming cable can break your winch.

When double lining during stationary winching, do not attach tow hooks to winch mounting plate.

Since the greatest pulling power is achieved on the innermost layer of your winch, it is desirable to pull off as much line as you can for heavy pulls. If this is not practical, use a snatch block and double line arrangement.

Neat, tight spooling avoids cable binding which is caused when a load is applied and the cable is pinched between two other wraps of cable. If this happens, alternately power the winch in and out a few inches. Do not attempt to work a bound cable under load, free by hand.

Techniques of Operation

The best way to get acquainted with how your winch operates is to make a few test runs before you actually need to use it.

Plan your test in advance.

Remember you hear your winch as well as see it operate. Get to recognize the sound of a light steady pull, a heavy pull, and sounds caused by load jerking or shifting. Soon you will gain confidence in operating your winch and its use will become second nature with you.

When pulling a heavy load, place a blanket, jacket or tarpaulin over the cable five or six feet from the

hook. It will slow the snap back in the event of a broken cable.

Plan your pull. You can't always hook up and pull out in one step. Examine all the areas for anchoring possibilities as well as leverage situations, direction, and goal.

General Operating Instructions

The winch clutch allows rapid unspooling of the wire rope for hooking onto the load or anchor point. The clutch is operated by the shifter located on the end of the winch as follows:

1. To disengage the clutch, turn the clutch shifter to the "FREESPOOL" position. Wire rope may now be freespooled off the drum.
2. To engage the clutch, turn the clutch shifter to the "ENGAGE" position. The winch is now ready for pulling.

Your battery must be kept in good condition. A fully charged battery and proper connections are essential. Run the vehicle engine during winching operations to keep battery charged.



General Installation

The winch shown in this owner's manual is designed solely and exclusively for non-industrial applications. All other applications will void warranty.

It is very important that the winch be mounted on a flat surface, with the cable underwound as shown in the dimensional drawing.

The dimensional drawing of the winch and solenoid are shown on the opposite page for use in determining a mounting location. Tighten mounting bolts to 16 ft-lbs torque.

Refer to *Electrical Connections and Operation* in this manual for instructions on installing the wiring for the winch and solenoid.

CAUTION: SUPPLIED 5/16-18NC X 7/8" LONG GRADE 5 MOUNTING BOLTS WITH LOCKWASHERS ARE FOR A RECOMMENDED WINCH MOUNTING PLATE THICKNESS OF 3/16". IF A DIFFERENT MOUNTING PLATE THICKNESS IS USED, THE BOLT LENGTH MUST BE ADJUSTED ACCORDINGLY OR DAMAGE TO WINCH MAY OCCUR. REPLACEMENT BOLTS MUST BE SAE GRADE 5 OR EQUIVALENT.

Maintenance

Corrosion on electrical connections will reduce performance or may cause a short. Clean all connections. In salty environments use a silicone sealer to protect from corrosion.

All moving parts in the winch are permanently lubricated with broad temperature range lithium-based grease.

Lubricate cable periodically using light penetrating oil. Inspect for broken strands and replace if necessary. If the cable becomes worn or damaged, it must be replaced.

To minimize corrosion of the internal motor components that may occur due to condensation, power the winch in or out periodically. Energizing the motor will generate heat, which will help dissipate any moisture buildup in the motor. This should be performed at periodic intervals (such as with each oil change to your vehicle). Note: Refer to the Troubleshooting Guide if the motor has been submerged.

Cable Installation

Note: Cable should be installed so that it feeds from the bottom of the drum.

Unwind the new cable by rolling it out along the ground to prevent kinking. Remove old cable and observe the manner in which it is attached to the cable drum flange, watching carefully for the cable anchor puck.

Before installing the new cable assembly, securely wrap the end of the cable with tape to prevent fraying.

Slide the cable through narrow end of the pocket against drum flange and wrap the cable around the anchor puck. Pull the cable and anchor back into the wide end of the pocket leaving approximately 1/8" beyond edge of pocket as shown. Use a hammer and drift punch to drive the back side of the wire rope, firmly seating the wire rope and anchor into the pocket.

Wind on the cable by pulling in a light load to keep the tension constant. Allow the cable to swivel by using a length of chain or a swivel block between the cable hook and the load.

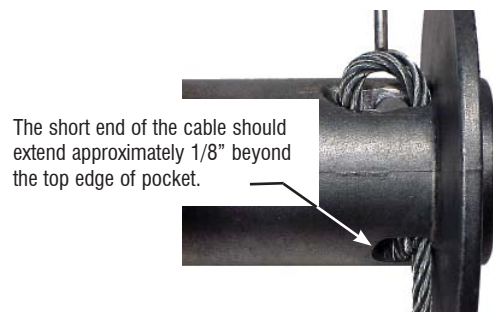

Winch Mounting

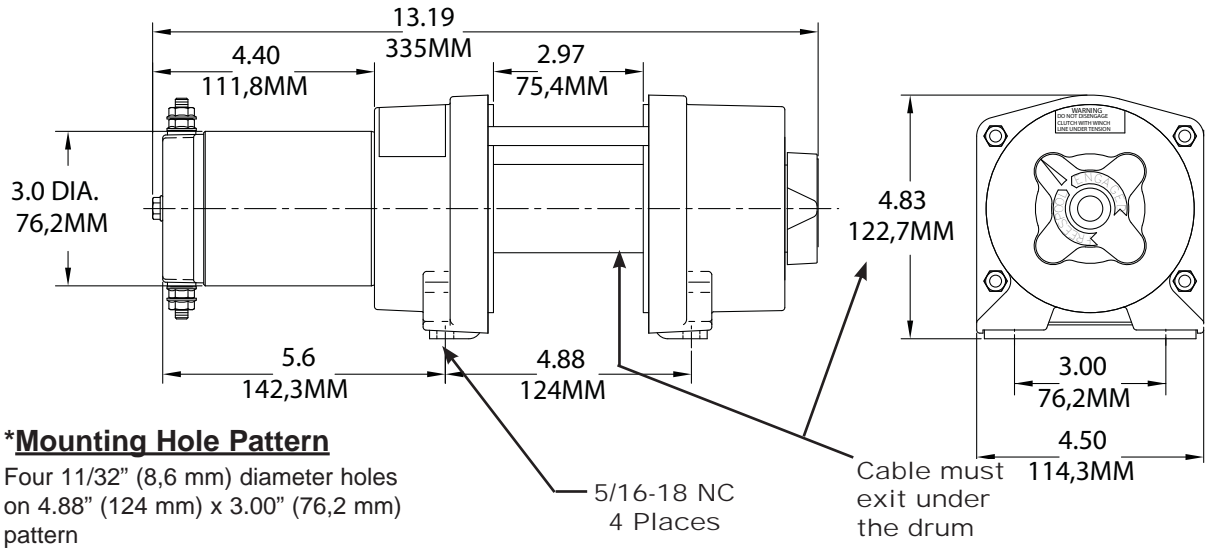

Solenoid Mounting

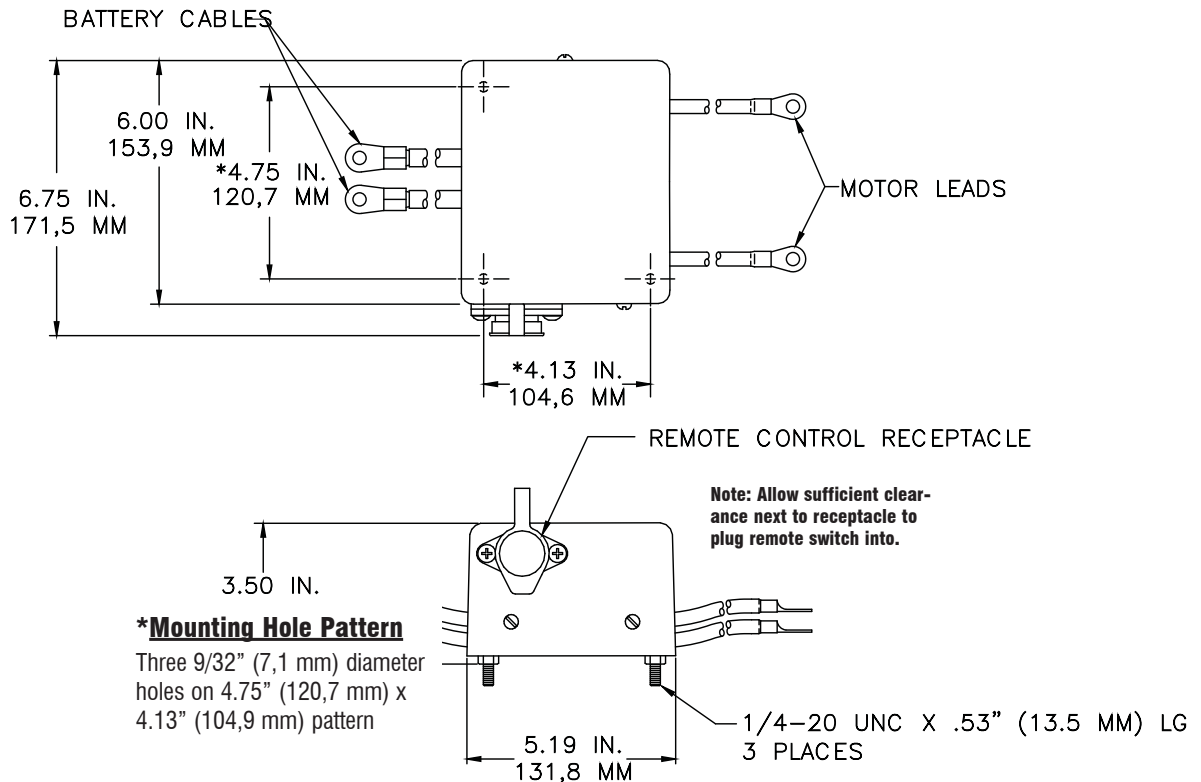

Electrical Schematic

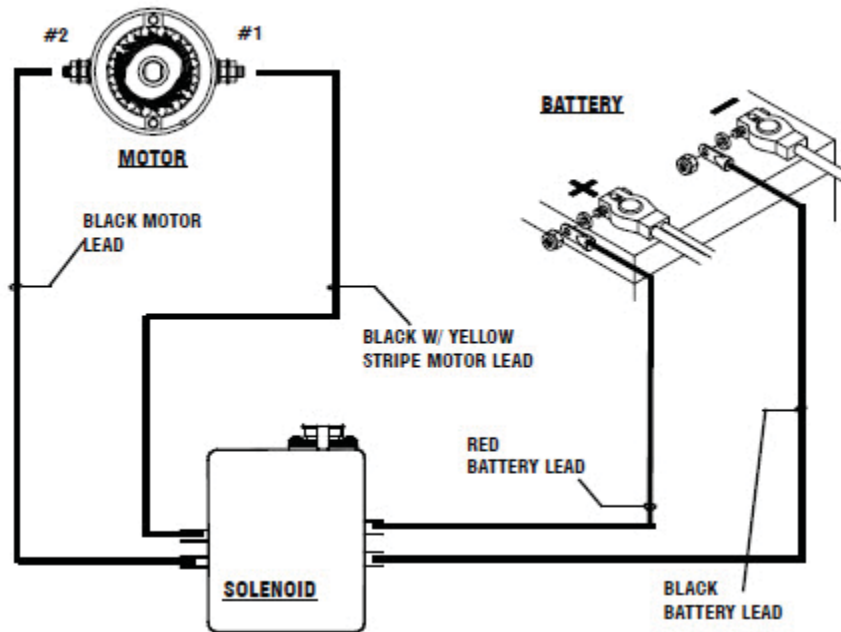

Electrical Connections and Operations

For normal self-recovery work, your existing electrical system is adequate. Your battery should be kept in good condition. A fully charged battery and proper connections are essential. Run the ATV engine during winching operations to keep battery charged.

The solenoid assembly controls the direction of cable drum rotation. Route red and black battery cables up to battery. **CAUTION: BE SURE BATTERY CABLES ARE NOT DRAWN TAUT ACROSS ANY SURFACES WHICH COULD POSSIBLY DAMAGE THEM.**

1. As shown on the schematic above, connect the red battery lead to the positive (+) terminal of the ATV battery.
2. Connect the black battery lead to the negative (-) terminal of the ATV battery.
3. Connect the black motor lead to the #2 pole of the motor.
4. Connect the black with yellow stripe motor lead to the #1 pole of the motor.
5. The remote switch plugs into the receptacle on the solenoid cover.

After the winch is installed and connected, run the winch forward and reverse to check connection and determine winch operating directions. Snap appropriate "IN" and "OUT" disc into proper thumb cavity. The switch is color coded (Red and White) to aid you in not having to guess which direction your winch will run in.

The remote control switch is waterproof. It has push button stations on either side. It is designed this way to prevent quick winch reversals which can lead to solenoid failure. Make sure the motor has stopped fully before reversing.

To actuate winch, simply plug the remote control switch into the receptacle in the solenoid cover. **DO NOT LEAVE SWITCH PLUGGED IN WHEN WINCH IS NOT IN USE.**

Parts List

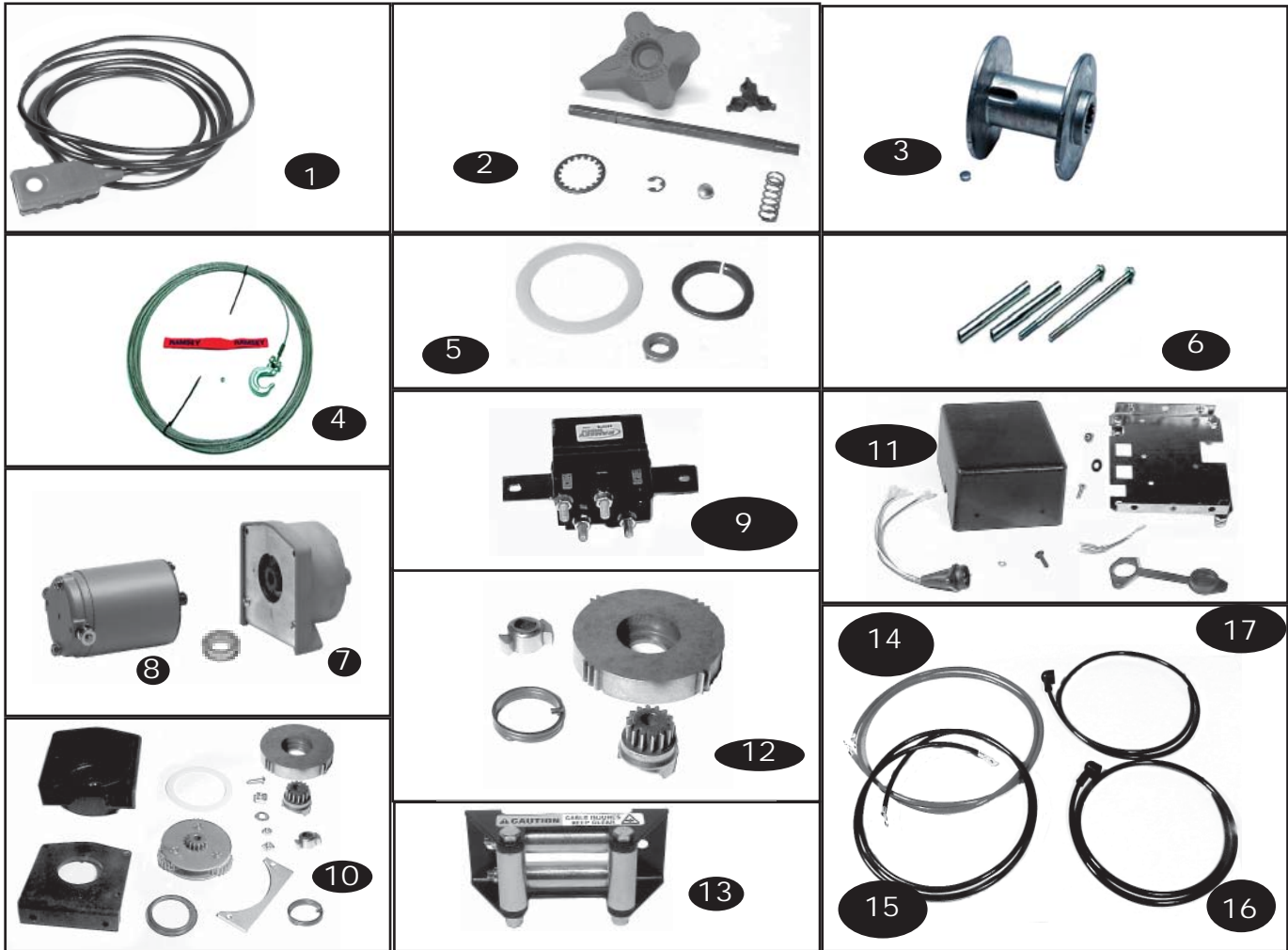

ITEM NO.	QTY	PART NO.	DESCRIPTION
1	1	251110	REMOTE SWITCH ASSY
2	1	251191	CLUTCH KIT
3	1	251192	CABLE DRUM KIT
4	1	251193	CABLE & HOOK KIT
5	1	251195	BUSHING KIT
6	1	251196	TIE BAR KIT
7	1	251213	CLUTCH END GEAR KIT
8	1	251214	MOTOR KIT
9	1	251234	SOLENOID KIT
10	1	251247	MOTOR END GEAR SET
11	1	251248	SOLENOID MOUNTING KIT
12	1	256116	BRAKE KIT
13	1	274030	ROLLER FAIRLEAD
14	1	289197	72" BLACK BATTERY LEAD
15	1	289199	72" RED BATTERY LEAD
16	1	289203	48" BLACK MOTOR LEAD
17	1	289204	48" BLACK W/ YELLOW STRIPE MOTOR LEAD

Trouble Shooting Guide

CONDITION	POSSIBLE CAUSE	CORRECTION
MOTOR RUNS IN ONLY ONE DIRECTION	Defective solenoid or stuck solenoid (Remote switch only).	Jar solenoid assembly to free contacts. Check each solenoid by applying + 12 volts to coil-terminal (it should make an audible click when energized).
	Defective remote switch plug (Remote switch only)	Disengage winch clutch, remove remote control switch from the socket and jump pins at 8 and 4 o'clock. Motor should run. Jump pins at 8 and 10 o'clock. Motor should run.
	Defective manual switch.	Replace manual switch.
MOTOR RUNS EXTREMELY HOT	Long period of operation	Cooling-off periods are essential to prevent overheating.
MOTOR RUNS, BUT WITH INSUFFICIENT POWER OR WITH LOW LINE SPEED	Insufficient battery.	Test for faulty vehicle battery
	Bad connection	Check battery cable for corrosion; clean and grease.
	Insufficient charging system	Replace with larger capacity charging system.
MOTOR RUNS, BUT DRUM DOES NOT TURN	Clutch not engaged	If clutch engaged but symptoms still exist, it will be necessary to disassemble winch to determine cause and repair.
MOTOR WILL NOT OPERATE	Defective solenoid or stuck solenoid (Remote switch only).	Jar solenoid assembly to free contacts. Check each solenoid by applying + 12 volts to coil-terminal (it should make an audible click when energized).
	Defective remote switch plug (Remote switch only)	Disengage winch clutch, remove remote control switch from the socket and jump pins at 8 and 4 o'clock. Motor should run. Jump pins at 8 and 10 o'clock. Motor should run.
	Defective manual switch.	Replace manual switch.
	Defective motor.	If solenoids operate, check for voltage at armature post; replace motor.
	Loose connections	Check all electrical connections from the battery to the motor.
MOTOR WATER DAMAGED	Submerged in water or water from high pressure car wash.	Allow to drain and dry thoroughly, then run motor without load in short bursts to dry windings.
WINCH RUNS IN OPPOSITE DIRECTION OF MANUAL SWITCH	Battery leads crossed	Reverse red and black battery leads.

NOTES

NOTES

NOTES

Warranty Information

Ramsey Winches are designed and built to exacting specifications. Care and skill go into every winch we make. If the need should arise, warranty procedure is outlined on the back of your self-addressed, postage paid warranty card. Please read and fill out the enclosed warranty card and send it to Ramsey Winch Company. If you have any problems with your winch, please follow instructions for prompt service on all warranty claims.

Limited Lifetime Warranty

Ramsey Winch offers a limited lifetime warranty for each new Ramsey winch against manufacturing defects in workmanship and materials on all manufactured components.

Warranty registration cards for each winch must be submitted at the time of purchase, or within 90 days. Online registration of your winch is available at www.ramsey.com.

New cable assemblies are warranted against defects in workmanship and materials. No warranty applies after initial use.

All Ramsey mounting kits and other accessories carry a 1-year limited warranty against defects in materials and workmanship. This warranty is void if winch is used in industrial applications.

Electrical components consisting of motors, solenoids, wiring, wire connectors, and associated parts carry a limited 1-year warranty. The obligation under this warranty, statutory or otherwise, is limited to the replacement or repair at the manufacturer's factory, or at a point designated by the manufacturer, of such part as shall appear to the manufacturer, upon inspection of such part, to have been defective in material or workmanship.

This Warranty does not obligate Ramsey Winch Company to bear the cost of transportation charges in connection with the replacement or repair of defective parts, nor shall it apply to a product upon which repairs or alterations have been made, unless authorized by the manufacturer, or for equipment misused, neglected, or improperly installed.

Important notice: To the fullest extent permitted by applicable law, the following are hereby excluded and disclaimed:

1. All warranties of fitness for a particular purpose;
2. All warranties of merchantability;
3. All claims for consequential or incidental damages.

There are no warranties that extend beyond the description that appears on the face hereof.

Some states do not allow the above exclusions or disclaimers in consumer transactions and as such this disclaimer/exclusion may not apply to your particular case.

To the extent such warranties of fitness for a particular purpose or merchantability are deemed to apply to this product, they exist only for so long as the express limited warranty elsewhere set forth is in existence. Ramsey Winch Company makes no warranty in respect to accessories, same being subject to the warranties of their respective manufacturers. Ramsey Winch Company, whose policy is one of continuous product improvement, reserves the right to improve any product through changes in design or materials as it may deem desirable without being obligated to incorporate such changes in products of previous manufacture.

If field service at the request of the buyer is rendered and the fault is found not to be with Ramsey Winch Company's product, the buyer shall pay the time and expense of the field representative. Bills for service, labor or other expenses which have been incurred by the buyer without express approval or authorization by Ramsey Winch Company will not be accepted.

This Warranty gives you specific legal rights and you may also have other legal rights which vary from state to state.

RAMSEY WINCH COMPANY

P.O. BOX 581510 TULSA, OKLAHOMA 74158-1510 USA PHONE: (918) 438-2760

FAX: (918) 438-6888 <http://www.ramsey.com>



914096 - 0713-E